

SYMBOL	DESCRIPTION
\$	SWITCH +48 - AT HEIGHT ABOVE FLOOR
\$ ₃ \$ ₄	3-WAY SWITCH, 4-WAY SWITCH
\$	SWITCHED OUTLET
\$ _E	EXISTING SWITCH
Φ	DUPLEX OUTLET A - ARC-FAULT OUTLET, E - EXISTING GFI - GROUND FAULT INTERRUPT OUTLET WP - WEATHER-PROOF OUTLET +46 - AT HEIGHT ABOVE FLOOR
Φ	SPECIAL/ DEDICATED OUTLET

	CEILING/WALL-MOUNTED LIGHT FIXTURE P.C. - PULL-CORD TYPE
	CAN LIGHT FIXTURE
	SMALL CAN LIGHT FIXTURE
	FLUORESCENT LIGHT FIXTURE
	TRACK LIGHTS
	CEILING EXHAUST FAN
	CEILING FAN/LIGHT JUNCTION BOX SCREWED TO SOLID BLOCKING OR CEILING JOIST - PROVIDE UL LISTED FAN BOX

	110 VOLT SMOKE DETECTOR WIRED IN SEQUENCE
	CARBON MONOXIDE DETECTOR WIRED IN SEQUENCE
	THERMOSTAT
	TELEPHONE OUTLET
	TV OUTLET
	ELECTRICAL SERVICE PANELBOX
	EMERGENCY LIGHTS WITH A BATTERY BACKUP
	EXIT LIGHT

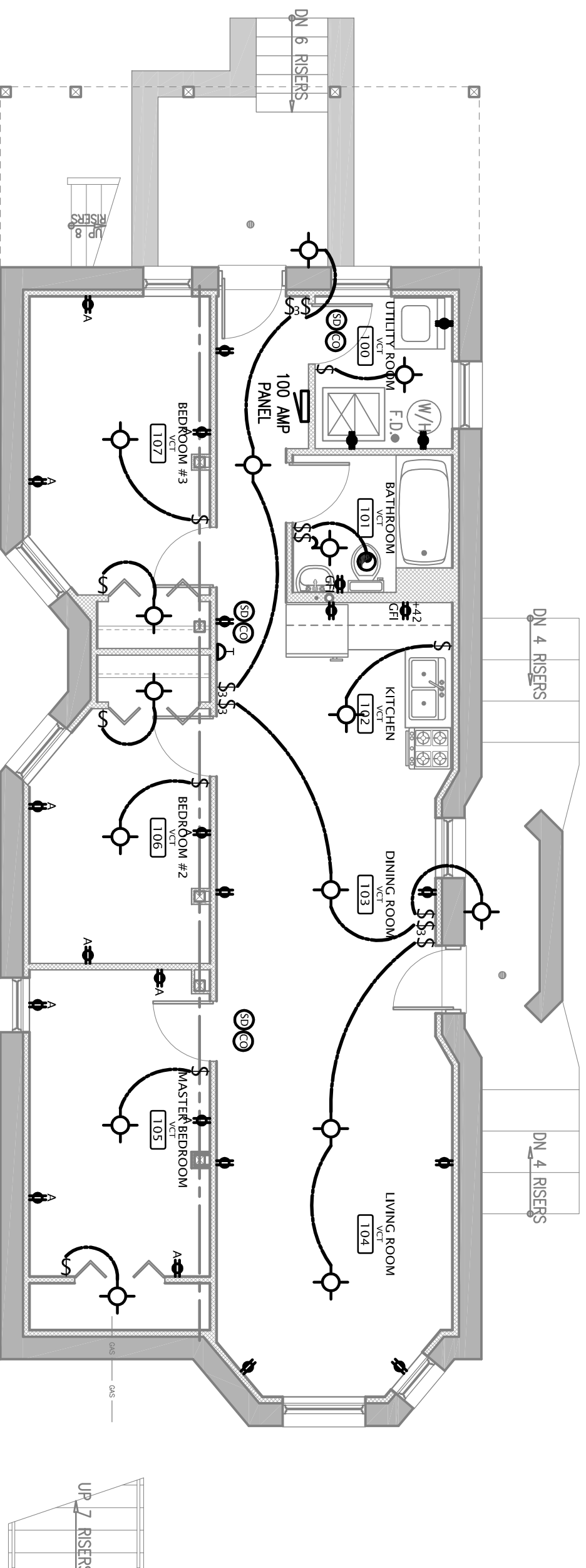

ELECTRICAL PLAN

SCALE: 1/4" = 1'-0"



419-C Harrison Street
Oak Park, IL 60304
Tel: (708) 948-7332
Fax: (708) 575-3004
@ us@kbpartnership.com

PROJECT NAME:
PROPOSED GARDEN UNIT

PROJECT ADDRESS:
1613 S. Central Park Av.
Chicago, IL 60623

SHEET TITLE:
ELECTRICAL PLAN

REVISIONS:
.....
.....
.....

ISSUED FOR PERMIT:
5-07-2009

This drawing is the sole property of KBP, Inc., and is protected under US copyright law and the Architectural Works Copyright Act of 1990. The copy of this drawing and/or distribution to unauthorized personnel or construction of the structure depicted herein without express written consent of KBP, Inc., would constitute infringement of KBP, Inc. The recipient of this drawing acknowledges and agrees that the ownership of the drawing and all other right, title, and interest therein, including without limitation, all rights under US Copyright and other intellectual property law, are retained by KBP, Inc.

COPYRIGHT © 2009
ALL RIGHTS RESERVED

SHEET NUMBER:

E.1