

NOTES:

1. ALL CONCRETE CONSTRUCTION SHALL COMPLY WITH ACI 318, BUILDING CODE REQUIREMENTS FOR REINFORCED CONCRETE AND ASTM C 150. ALL CONCRETE SHALL ATTAIN A MINIMUM 28 DAY COMPRESSIVE STRENGTH OF 3,000 P.S.I.
2. THE CONCRETE SUB-CONTRACTOR SHALL BE RESPONSIBLE FOR THE COORDINATION WITH THE GENERAL CONTRACTOR FOR THE PLACING OF ALL SLEEVES IN SLABS AND FOUNDATION WALL FOR TELEPHONE, PLUMBING, ELECTRICAL AND MECHANICAL TRADES.
3. THE CONCRETE SUB-CONTRACTOR SHALL INSTALL FOUNDATION REINFORCING STEEL, ANCHOR BOLTS, ETC. IN CONFORMANCE WITH THE SIZE AND SHAPES INDICATED ON THE DRAWINGS AND AS MAY BE REQUIRED BY THE NATURE OF THE WORK.
4. THE CONCRETE SUB-CONTRACTOR SHALL SEAL ALL INTERIOR SLABS AND EXPOSED INTERIOR CONCRETE WITH ONE COAT OF CLEAR CONCRETE SEALER.
5. ALL SLABS SHALL HAVE 6 X 6 10/10 W.W.F. PROVIDE EXPANSION JOINTS W/FILLER AND CONTROL JOINTS PER ACI RECOMMENDED PRACTICE.

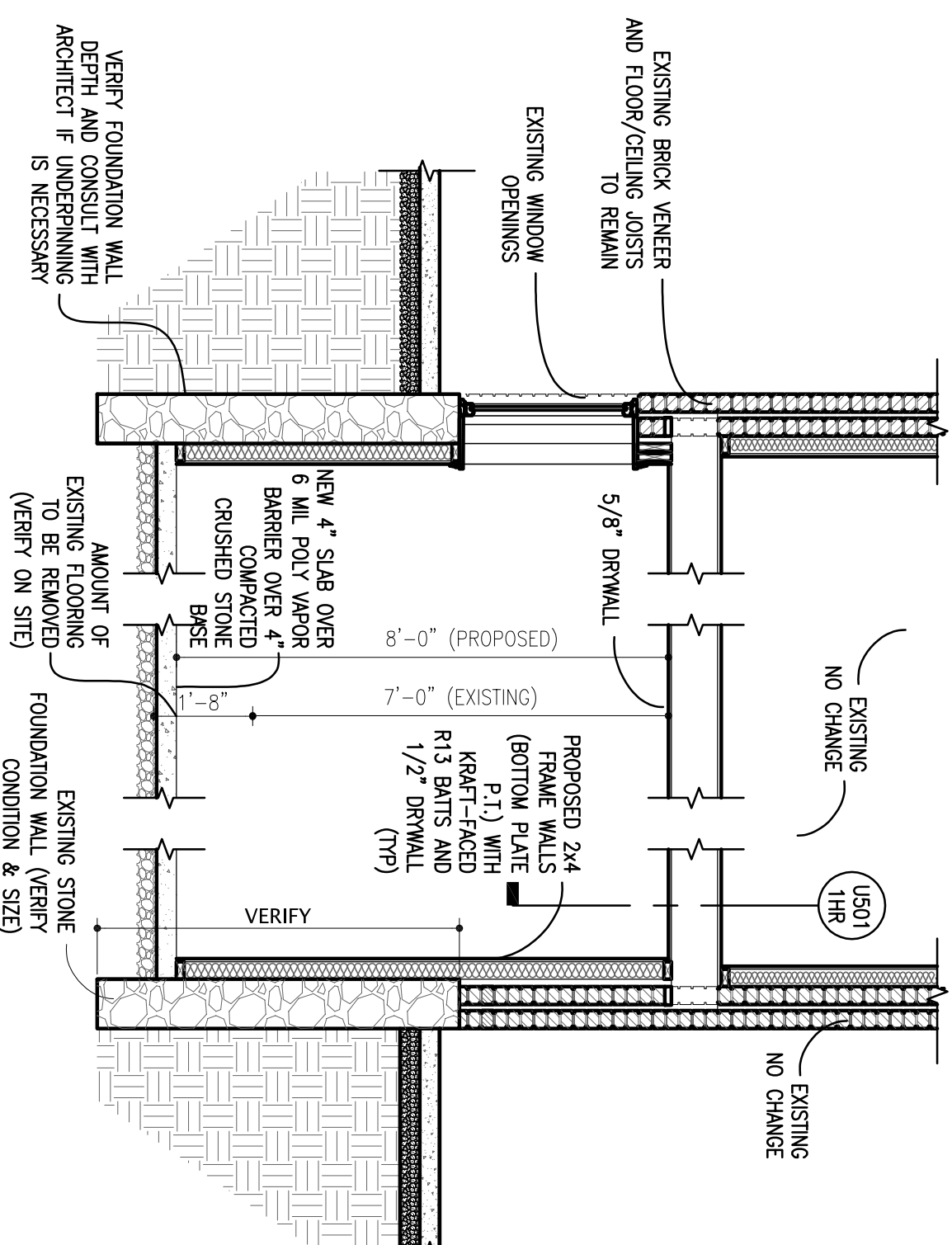

BUILDING SECTION

SCALE: 3/8" = 1'-0"

1
A.5



419-C Harrison Street
Oak Park, IL 60304
tel: (708) 948-7332
fax: (708) 575-3004
@: us@kbpartnership.com

PROJECT NAME:
PROPOSED GARDEN UNIT

PROJECT ADDRESS:
1613 S. Central Park Av.
Chicago, IL 60623

SHEET TITLE:
SECTION & DETAILS

REVISIONS:

.....

.....

.....

.....

ISSUED FOR PERMIT:
5-07-2009

This drawing is the sole property of KBP, Inc., and is protected under US Copyright law and the Architectural Works Protection Act of 1990. The copy of this drawing and/or distribution to unauthorized personnel or construction of the structure depicted herein without express written consent of KBP, Inc., would constitute infringement of KBP, Inc. The recipient of this drawing acknowledges and agrees that the ownership of the drawing and all other right, title, and interest therein, including without limitation, all rights under US Copyright and other intellectual property laws, are retained by KBP, Inc.

COPYRIGHT © 2009
ALL RIGHTS RESERVED

SHEET NUMBER:

A.5